

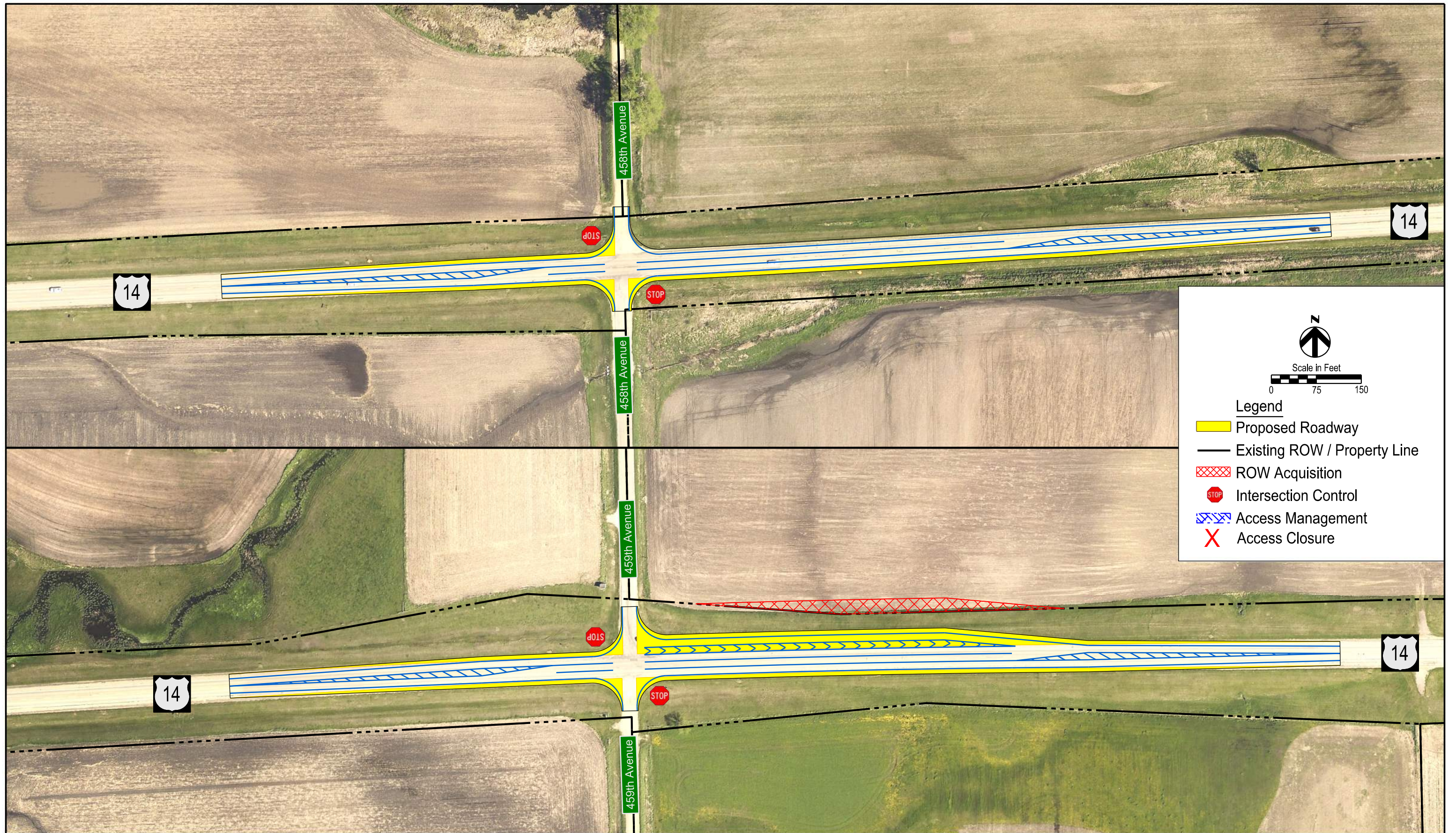

# US14 – West of Volga

## Scenario A: Maintain 2-Lane Highway with Intersection Improvements





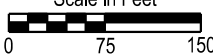

Scenario includes:

- US14/US81 intersection improvements
- 458<sup>th</sup> Avenue intersection turn lanes
- 459<sup>th</sup> Avenue intersection turn lanes



  
 Scale in Feet  

**Legend**

-  Proposed Roadway
-  Existing ROW / Property Line
-  ROW Acquisition
-  Intersection Control
-  Access Management
-  Access Closure

# US14 – West of Volga

## Scenario B: Maintain 2-Lane Highway with Passing Lanes and Intersection Improvements

Scenario includes:

- Two 1.5-mile westbound passing lane/multilane segments:
  - 1.5 mile passing lane east of 459<sup>th</sup> Avenue
  - Multilane highway extended approximately 1.5 miles west of Volga
- One eastbound passing lane and extension of US14 multilane west out of Volga:
  - 1.5 mile passing lane east of 459<sup>th</sup> Avenue
  - Multilane highway extended approximately 0.5 miles west of Volga
- US14/US81 intersection improvements
- 458<sup>th</sup> Avenue intersection turn lanes
- 459<sup>th</sup> Avenue intersection turn lanes

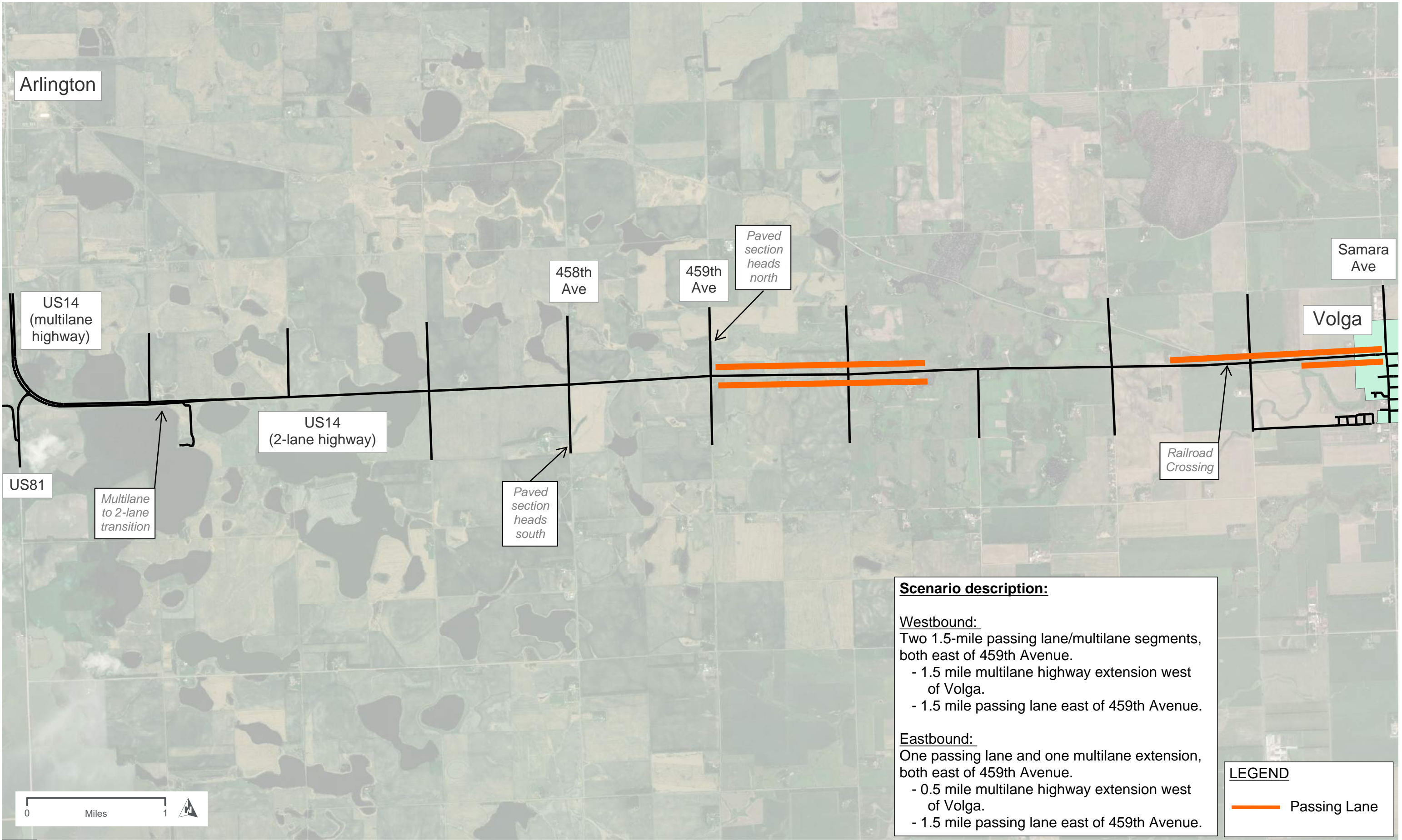

**Scenario description:**

Westbound:  
 Two 1.5-mile passing lane/multilane segments, both east of 459th Avenue.  
 - 1.5 mile multilane highway extension west of Volga.  
 - 1.5 mile passing lane east of 459th Avenue.

Eastbound:  
 One passing lane and one multilane extension, both east of 459th Avenue.  
 - 0.5 mile multilane highway extension west of Volga.  
 - 1.5 mile passing lane east of 459th Avenue.

**LEGEND**

— Passing Lane



14

14

14

14

459th Avenue





459th Avenue

460th Avenue

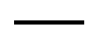

Scale in Feet  
0 100 200

Legend

-  Proposed Roadway
-  Existing ROW / Property Line
-  ROW Acquisition
-  Intersection Control
-  Access Management
-  Access Closure

Figure



US14 West of Volga - Scenario B









US14 West of Volga Scenarios  
Two WB Passing Lanes East of 459th Avenue  
US14 / US14B Corridor Study

Brookings, SD



  
 Scale in Feet  

**Legend**

-  Proposed Roadway
-  Existing ROW / Property Line
-  ROW Acquisition
-  Intersection Control
-  Access Management
-  Access Closure

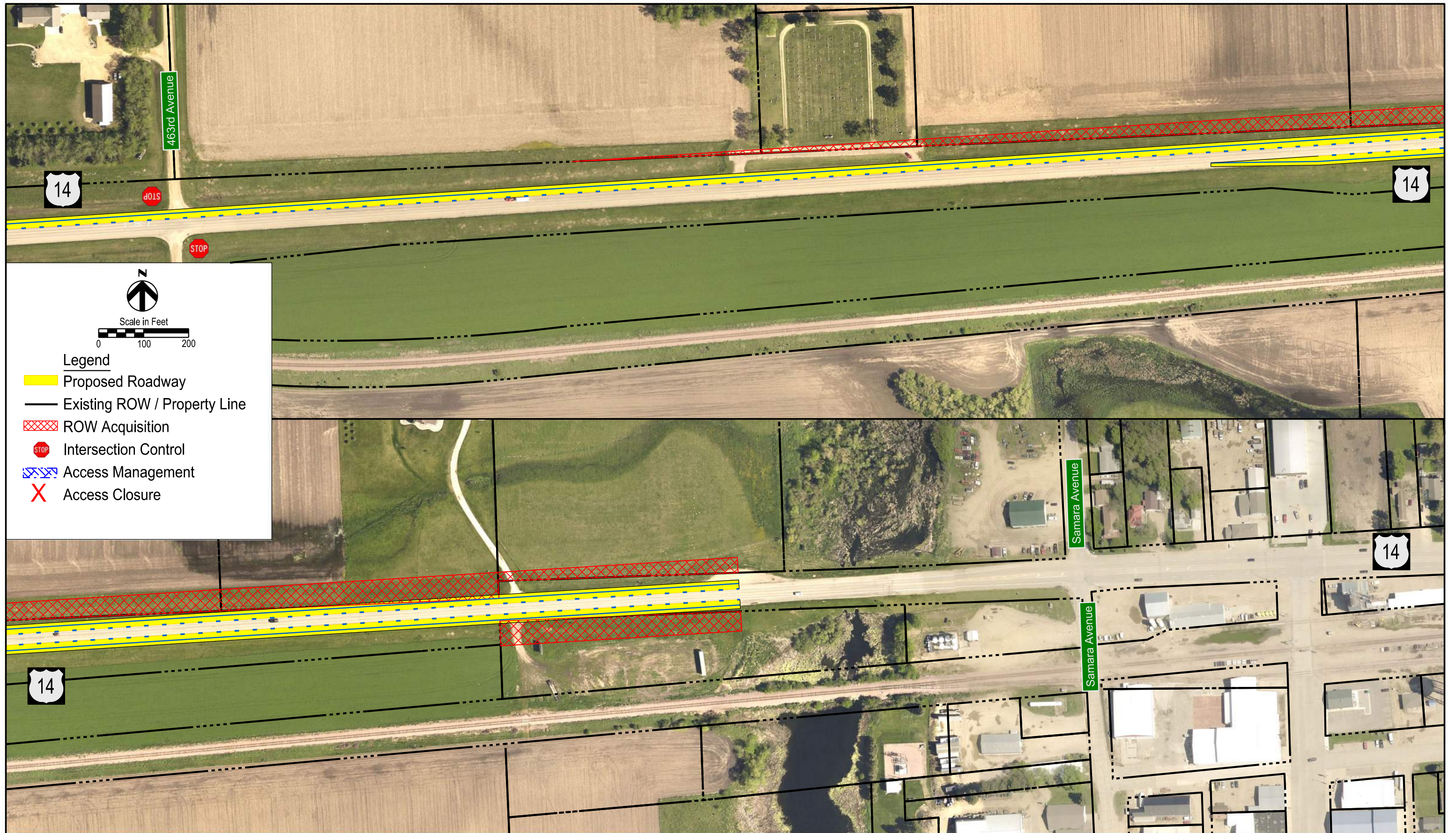

US14 West of Volga Scenarios  
 Two WB Passing Lanes East of 459th Avenue  
 US14 / US14B Corridor Study

Brookings, SD

Figure  
 US14 West of Volga - Scenario B

# US14 – West of Volga

## Scenario C: Maintain 2-Lane Highway with Passing Lanes and Intersection Improvements

Scenario includes:

- Two 1.5-mile westbound passing lane/multilane segments:
  - 1.5 mile passing lane east of 459<sup>th</sup> Avenue
  - Multilane highway extended approximately 1.5 miles west of Volga
- One eastbound passing lane and extension of US14 multilane west out of Volga:
  - 1.5 mile passing lane east of 459<sup>th</sup> Avenue
  - Multilane highway extended approximately 0.5 miles west of Volga
- US14/US81 intersection improvements
- 458<sup>th</sup> Avenue intersection turn lanes
- 459<sup>th</sup> Avenue intersection turn lanes

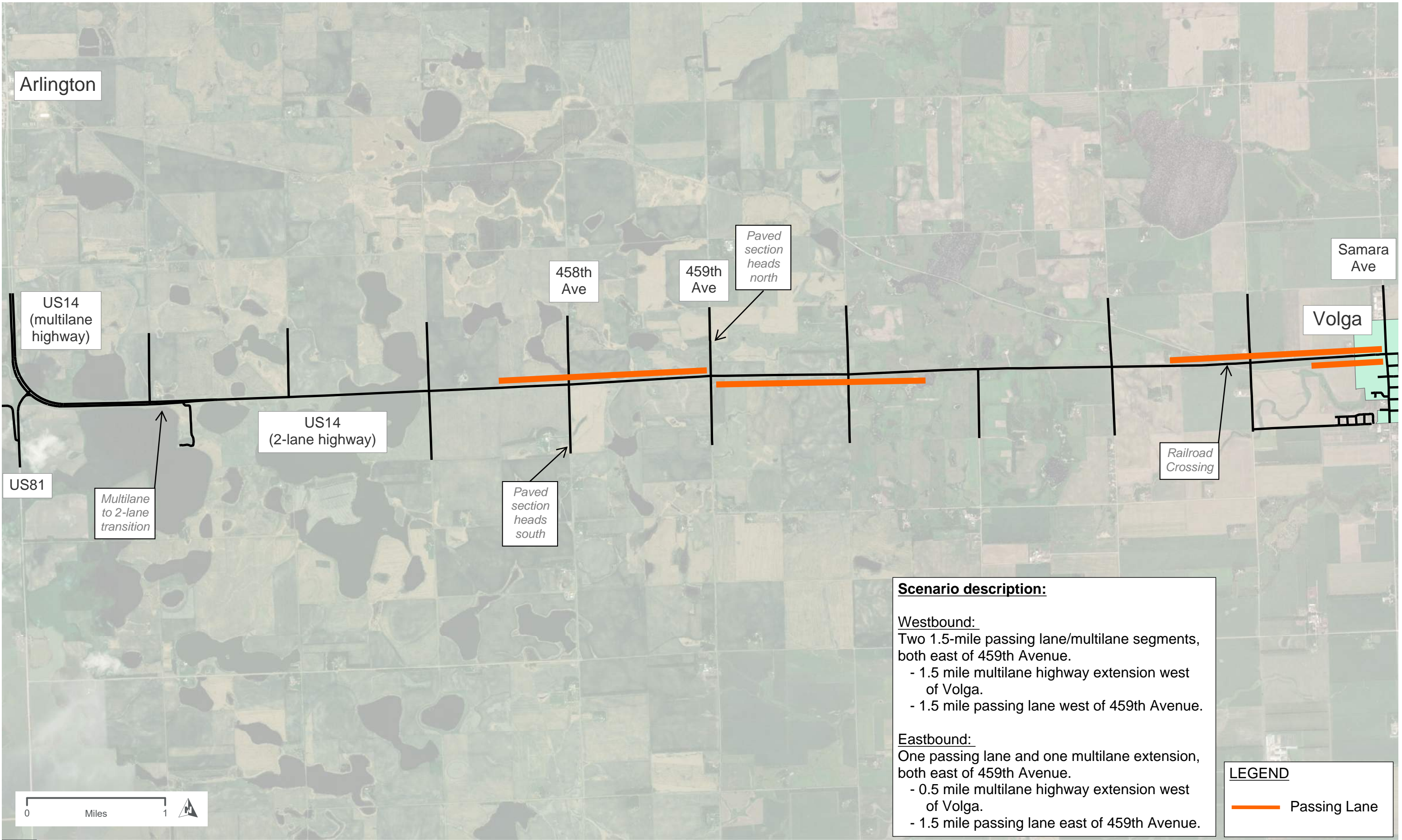

**Scenario description:**

Westbound:  
 Two 1.5-mile passing lane/multilane segments, both east of 459th Avenue.  
 - 1.5 mile multilane highway extension west of Volga.  
 - 1.5 mile passing lane west of 459th Avenue.

Eastbound:  
 One passing lane and one multilane extension, both east of 459th Avenue.  
 - 0.5 mile multilane highway extension west of Volga.  
 - 1.5 mile passing lane east of 459th Avenue.

**LEGEND**

— Passing Lane



US14 West of Volga Scenarios  
 Two WB Passing Lanes, 1 East and 1 West of 459th Avenue  
 US14 / US14B Corridor Study

Brookings, SD





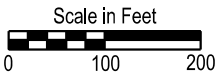

Figure

US14 West of Volga - Scenario C



  
 Scale in Feet  

**Legend**

-  Proposed Roadway
-  Existing ROW / Property Line
-  ROW Acquisition
-  Intersection Control
-  Access Management
-  Access Closure



US14 West of Volga Scenarios  
 Two WB Passing Lanes, 1 East and 1 West of 459th Avenue  
 US14 / US14B Corridor Study





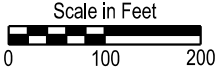

Brookings, SD

Figure  
 US14 West of Volga - Scenario C



  
 Scale in Feet  

**Legend**

-  Proposed Roadway
-  Existing ROW / Property Line
-  ROW Acquisition
-  Intersection Control
-  Access Management
-  Access Closure

463rd Avenue

463rd Avenue

STOP

STOP

STOP

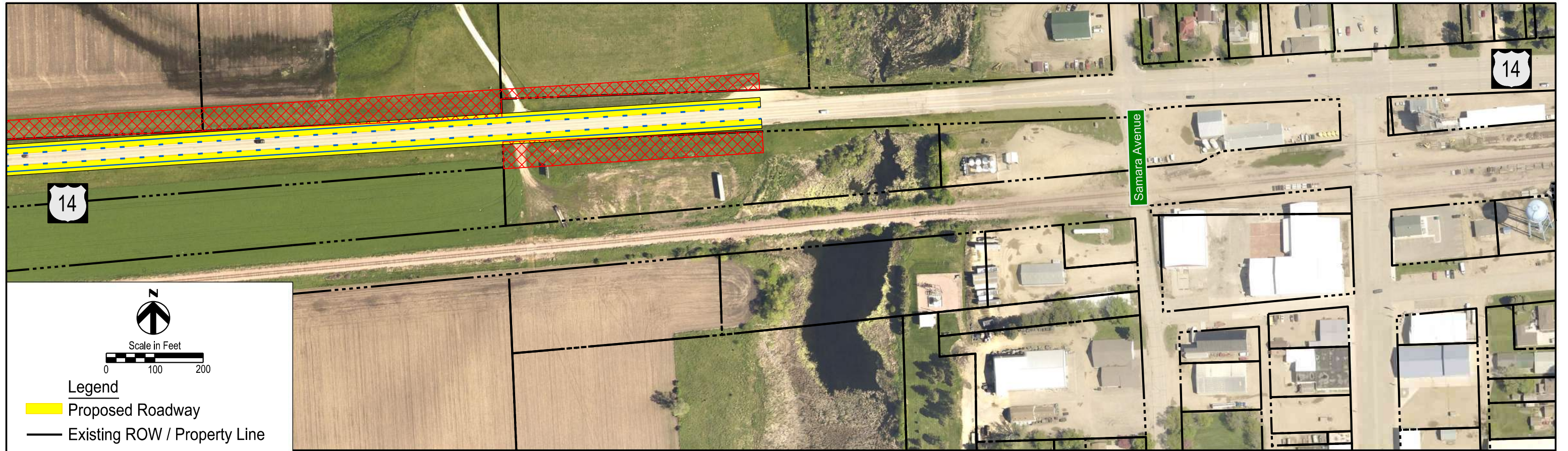

Scale in Feet

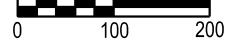

**Legend**

- Proposed Roadway
- Existing ROW / Property Line
- ROW Acquisition
- STOP Intersection Control
- Access Management
- X Access Closure



Samara Avenue



US14 West of Volga Scenarios  
 Two WB Passing Lanes, 1 East and 1 West of 459th Avenue  
 US14 / US14B Corridor Study

Brookings, SD

Figure  
 US14 West of Volga - Scenario C

# US14 – West of Volga

## Scenario D: Multilane Divided Highway with Intersection Improvements







Scenario includes:

- Multilane divided highway between US81 intersection (existing multilane segment) and Volga (existing multilane segment).
- US14/US81 intersection improvements
- 458<sup>th</sup> Avenue intersection turn lanes
- 459<sup>th</sup> Avenue intersection turn lanes



Scale in Feet  
0 100 300

**Legend**

-  Proposed Roadway
-  Remove Roadway
-  Existing ROW / Property Line
-  ROW Acquisition
-  Intersection Control
-  Access Management
-  Access Closure

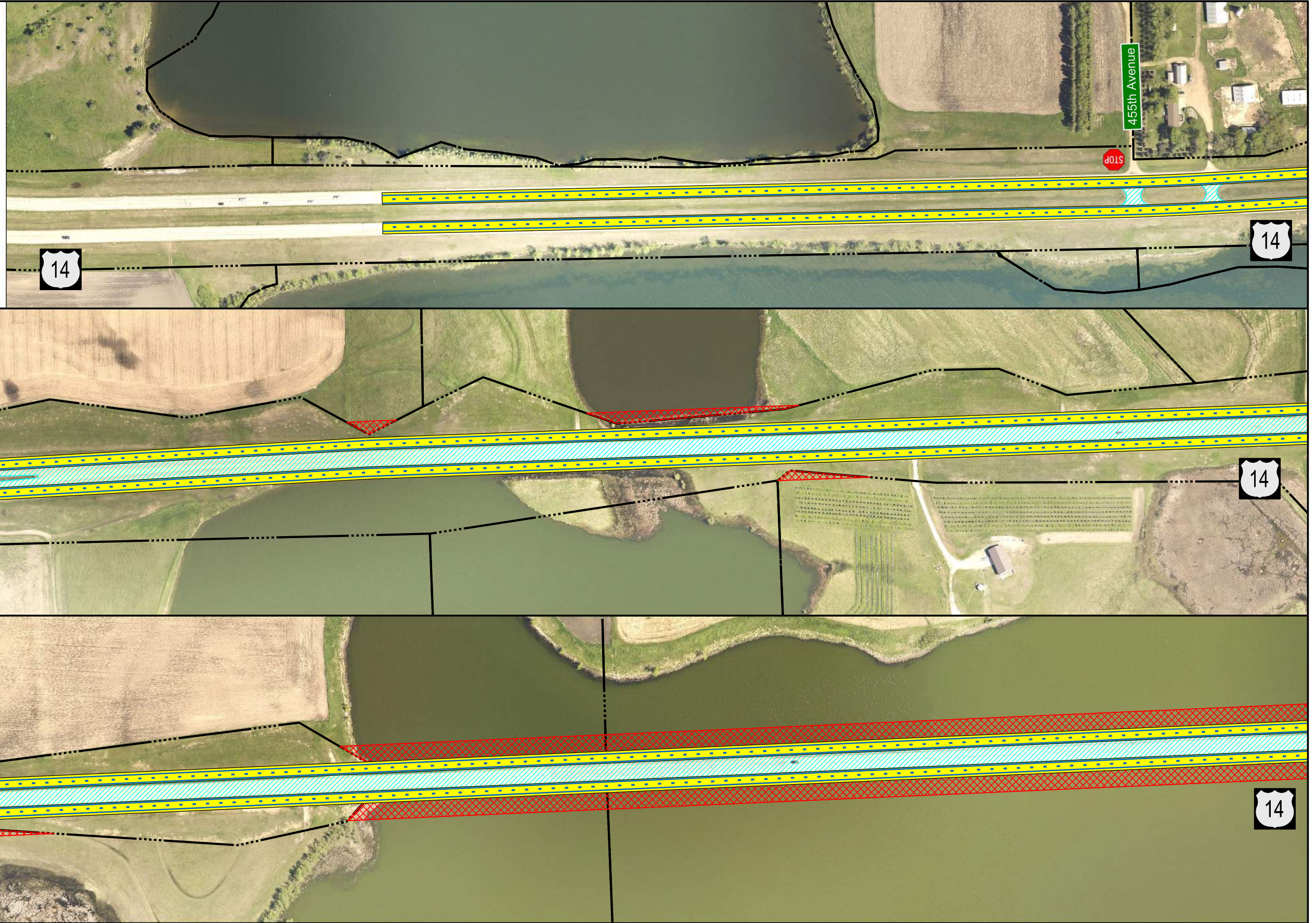

US14 West of Volga Scenarios  
 4-Lane Divided with Intersection Improvements  
 US14 / US14B Corridor Study

Figure  
 US14 West of Volga - Scenario D  
 Brookings, SD

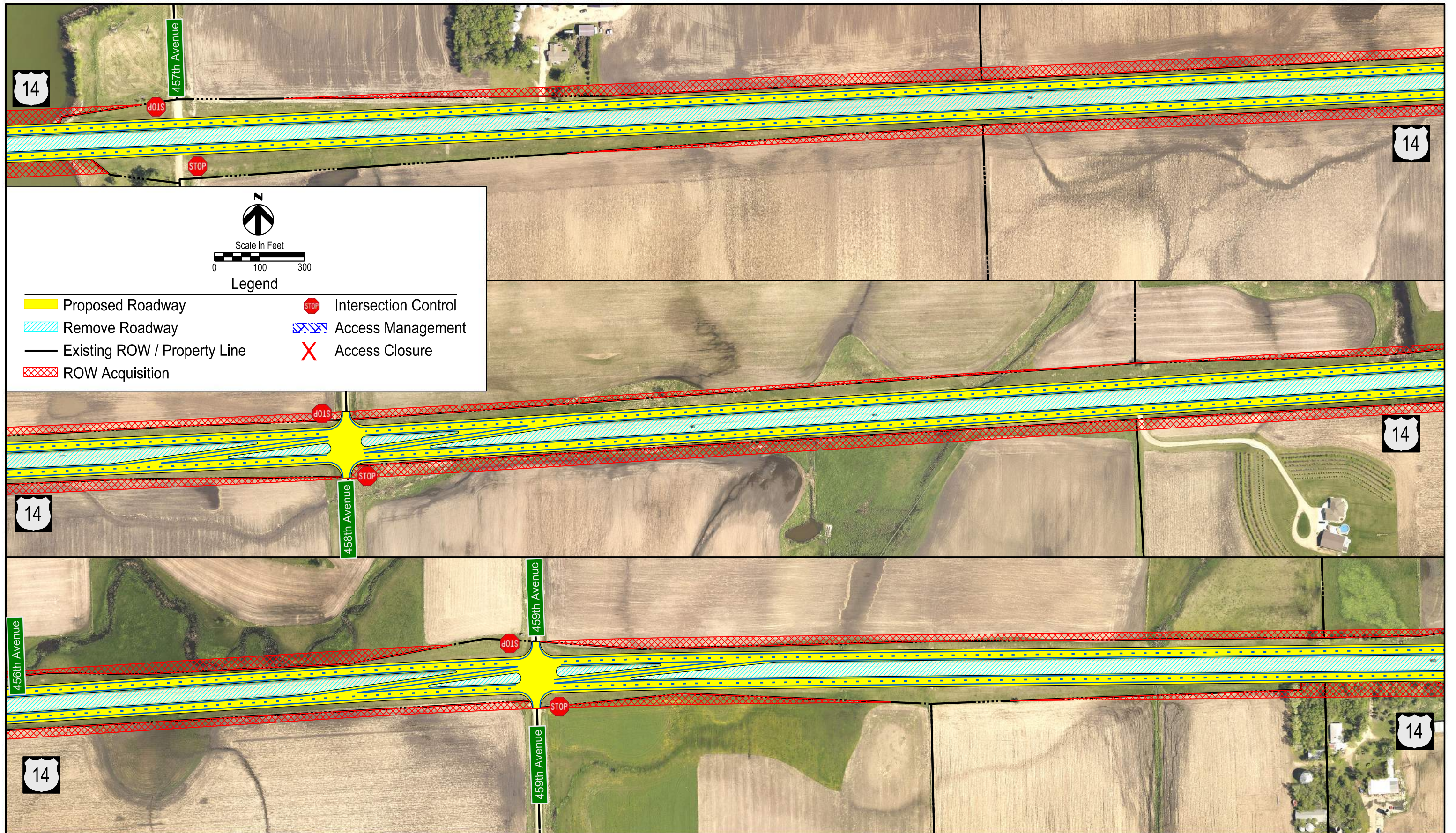

US14 West of Volga Scenarios  
 4-Lane Divided with Intersection Improvements  
 US14 / US14B Corridor Study

Brookings, SD

Figure  
 US14 West of Volga - Scenario D

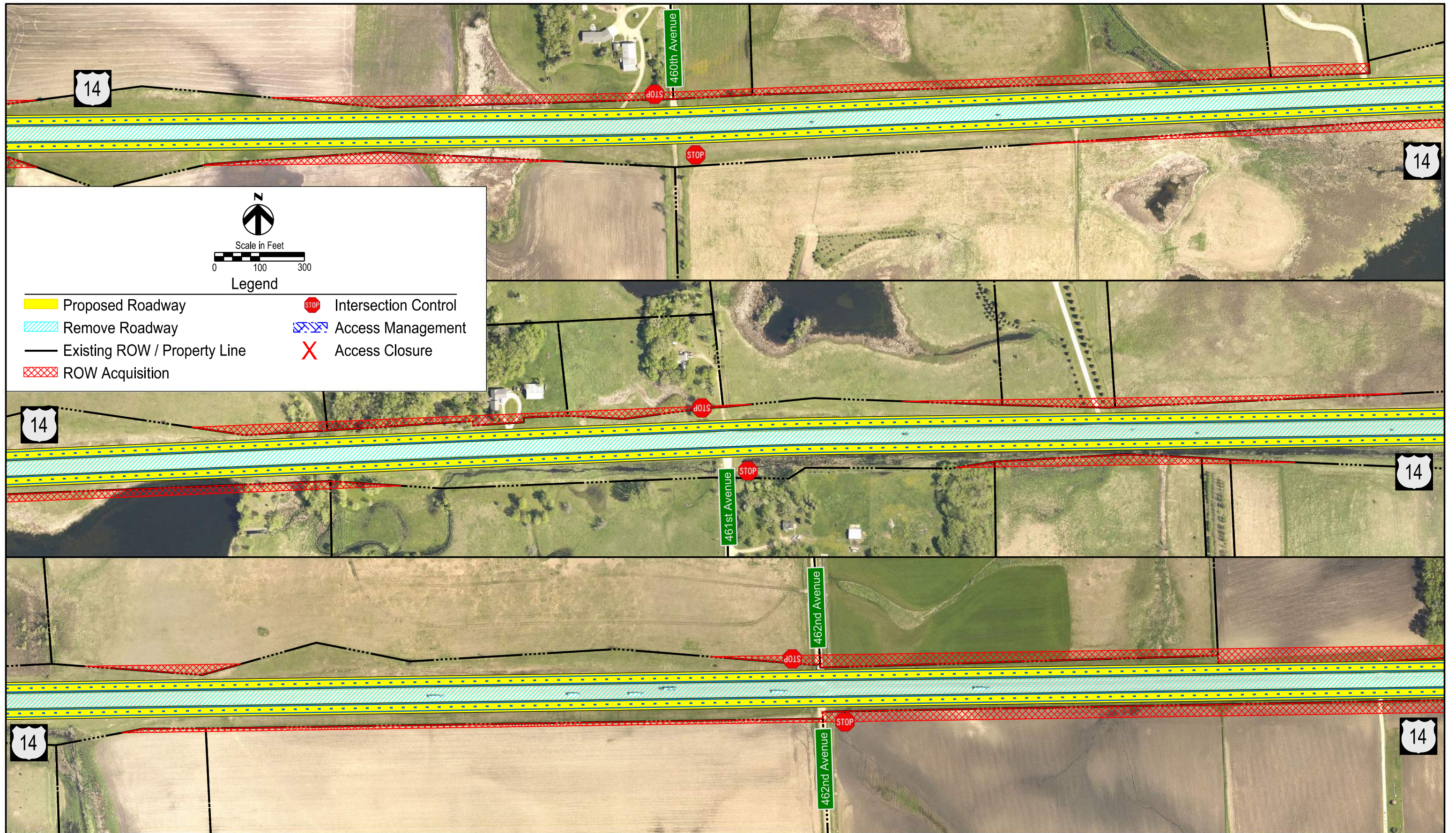

US14 West of Volga Scenarios  
 4-Lane Divided with Intersection Improvements  
 US14 / US14B Corridor Study

Brookings, SD

Figure  
 US14 West of Volga - Scenario D

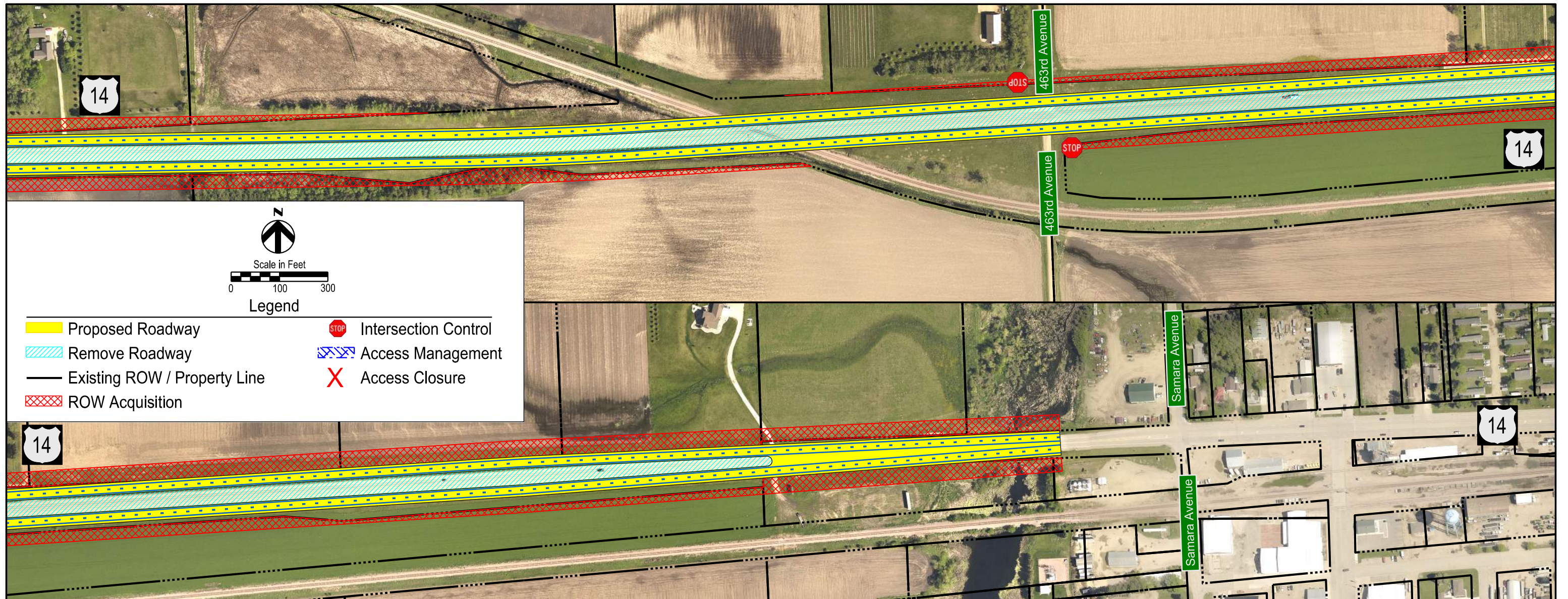

US14 West of Volga Scenarios  
 4-Lane Divided with Intersection Improvements  
 US14 / US14B Corridor Study

Brookings, SD

Figure  
 US14 West of Volga - Scenario D

# US14 – West of Volga

## US14/US81 Intersection Improvements

Layout reflects proposed 3.43-mil reconstruction project planned for 2023. This option is applicable with any of the four US14 – West of Volga corridor segment scenarios.

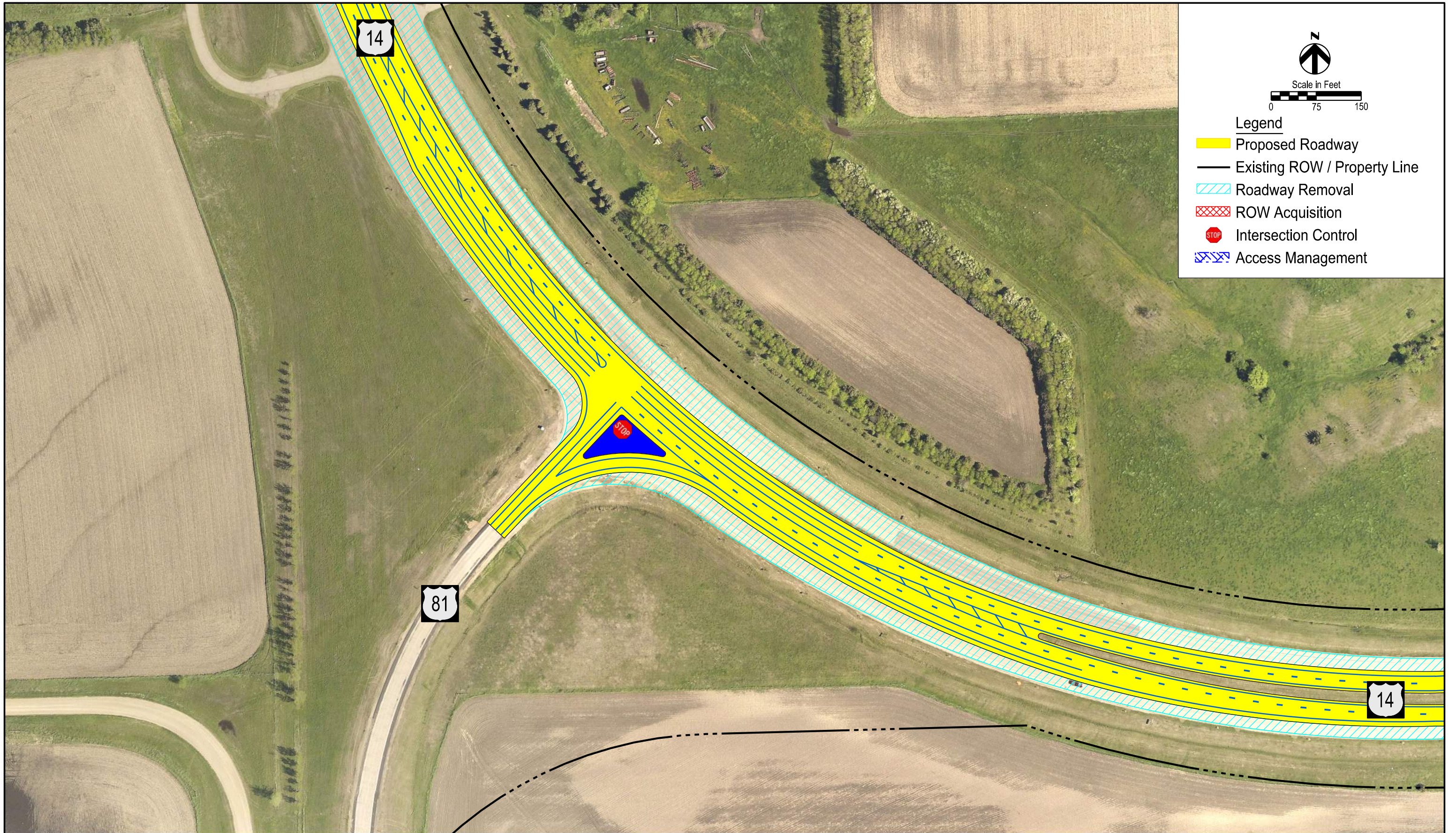

US14 West of Volga Concepts  
 US14/US81 Intersection Improvements - Narrow US14 Median  
 US14 / US14B Corridor Study

Brookings, SD

Figure  
 US14/US81 Intersection - Option A

# US14 – West of Volga Scenarios

## Improvement Scenarios

Scenario A: Maintain 2-Lane Highway with Intersection Improvements

Scenario B: Maintain 2-Lane Highway with Passing Lanes and Intersection Improvements

Scenario C: Maintain 2-Lane Highway with Passing Lanes and Intersection Improvements

Scenario D: Multi-lane Divided Highway with Intersection Improvements

US14/US81 Intersection Option: Layout reflects proposed 3.43-mil reconstruction project planned for 2023 (applicable to any of the four corridor scenarios).

## Preliminary Summary Matrix

Scenario	2050 Traffic Operations				Predictive Safety		ROW & Costs		Environmental Impacts
	Includes warranted turn lanes?	Intersection Operations (LOS)	US14 Corridor Operations (LOS)	Corridor Reliability & Driver Expectancy	F&I Crashes	Total Crashes	ROW Acquisition	Construction & ROW Costs	Potential Impacts
	Yes/No	AM / PM	AM / PM	5 - Best 3 - Middle 1 - Least	Average Annual # Crashes	Average Annual # Crashes	Acres	\$ mil	Low, Medium, High
Scenario A	Yes	LOS A or better	B / C	3	4.9	14.3	< 0.5	\$0.5	Low
Scenario B	Yes	LOS A or better	B / C	4	5.3	14.6	3.5	\$6.0	Medium - Wetlands
Scenario C	Yes	LOS A or better	B / C	4	5.2	14.3	3.5	\$6.5	Medium - Wetlands
Scenario D	Yes	LOS A or better	A / A	5	7.7	14.5	47	\$39.5	High - Wetlands
No Build	No	LOS A or better	B / C	2	6.6	17.9	0	0	Low
US14/US81 Intersection Option	n/a	LOS A or better	-	-	-	-	< 0.5	\$7.7*	Low

\* Approved 2020 STIP cost.